

# SOCIETY FOR FAMILY HEALTH RWANDA



P.O. Box 3040 Kigali, Rwanda  
**Plot No:** 99, KG 543 Street, Kacyiru, Gasabo District, Kigali  
**Tel:** +250-78830685;

Email for Clarification or inquiry: [procurement@sfrwanda.org](mailto:procurement@sfrwanda.org)

**TENDER:** CONSTRUCTION WORKS OF TEN (10) SECOND-GENERATION HEALTH POST IN RWANDA- PHASE 1

**TENDER REFERENCE NUMBER:** 03/ CONSTRUCTION WORKS OF TEN (10) SGHPS- PHASE 1 /TAKEDA/SFH/2024

**PROJECT SOURCE OF FUNDS:** TAKEDA

**Procurement Method:** National Open Competitive Tender

**APRIL,2024**

## **Title of the Tender:** CONSTRUCTION WORKS OF TEN (10) SECOND-GENERATION HEALTH POSTs IN RWANDA- PHASE 1

SOCIETY FOR FAMILY HEALTH RWANDA (SFH Rwanda) wishes to sign a contract with contractors of Construction Works of Ten (10) Second-Generation Health Posts under the Works Tender registered for companies located in Kigali City that will provide Supplies to SFH Rwanda; all in a Works agreement.

Bidders are encouraged to respond with their best price initially, as there may not be an opportunity to submit revised bids. All offers should be on a *fixed prices* basis and should be submitted in a sealed envelope to SFH Rwanda reception.

### **General Information about SFH Rwanda**

SFH is a non-profit organization, established in 2012 under the laws of Rwanda. SFH is organized exclusively for social marketing purposes, with primary focus in public health.

Society for Family Health (SFH) Rwanda, P.O Box.3040, Kigali is currently located on King Faisal Hospital Road, Kacyiru; Opposite Radio Voice of Hope.

## **PART I: TENDER SUMMARY**

SFH Rwanda invites you to bid through a competitive tender process on equal ground; please read the tender package carefully and comply with all submission guidelines using the tender reference number above for all correspondences. Failure to comply with submission guidelines may prompt SFH Rwanda to disqualify your submission.

The table below provides basic information about the Construction Works of Ten (10) Second-Generation Health Posts Tender; including the proposed type of award contract should the Company be selected from this process.

<b>TENDER SUMMARY</b>	
Works being tendered	CONSTRUCTION WORKS OF TEN (10) SECOND-GENERATION HEALTH POSTS BY TAKEDA- PHASE 1
Type of contract planned	One time order contract
Date tender launched	<b>16<sup>th</sup> April 2024</b>
Submission deadline	<b>16<sup>th</sup> May 2024 at 11h30 local time</b>
Public opening date	<b>16<sup>th</sup> May 2023 at 11h45 local time</b>
Public opening location	SFH Rwanda conference room
Location of Company	ONLY Bid Companies located in Kigali City are allowed to bid

Inquiry contact email	<a href="mailto:procurement@sfhrwanda.org">procurement@sfhrwanda.org</a>
Deadline for Inquiries	2 days before submission deadline

## PART II: BID SUBMISSION GUIDELINES

### II.1 Format and Content of Bids

Bidders MUST comply with the format and content instructions in the table below. Failure to comply with the submission format and content below may disqualify your offer.

BID FORMAT AND CONTENT	
<b>N# of bid copies required</b>	Signed and stamped (1 ORIGINAL AND 1 PHOTOCOPY)
<b>Bid language</b>	English
<b>Minimum Bid Contents</b>	Signed submission letter
	Signed and stamped financial offer Bid
<b>Bid currency</b>	Rwandan Francs
<b>Bid pricing</b>	VAT Exclusive ( <i>ALL BIDDING COMPANIES MUST BE ABLE TO OFFER EBM RECEIPTS</i> )
<b>Bid validity</b>	At least 90 days from bid receipt
<b>Bid submission format</b>	Hand delivery by hard copy in a sealed envelope signed or stamped across the seal. <b>NOTE: NO ELECTRONIC SUBMISSION ALLOWED</b>
<b>Complete Bid submission Address</b>	<b>SFH RWANDA</b> “CONSTRUCTION WORKS OF TEN (10) SECOND-GENERATION HEALTH POSTs Tender” Attention: Executive Director BP 3040; on King Faisal Hospital Road; Kigali, Rwanda. Telephone: 0788305685 Tender Ref. N#: 03/ CONSTRUCTION WORKS OF TEN (10) SECOND-GENERATION HEALTH POSTs- PHASE 1/TAKEDA /SFH/2024

### II.2 Submission and Handling of Bids

(a) Bids are to be delivered by hand delivery/courier in a ***sealed*** envelope at SFH Rwanda reception desk to the submission address above in section II.1.

(b) In order to be considered, the original bid must be received at the above address or number (as applicable) no later than the submission deadline in Part 1. Bidders are solely responsible to ensure the timely receipt of their bids. Bids received after the date and time required will generally not be considered unless no other bids are received.

(c) Bids must follow the format and content described in section II.1. Incomplete bid or bids which do not follow the submission guidelines may be disqualified from consideration. Each bid must include a manually signed, stamped fully binding one original Bid, and one (1) copy, valid for ninety (90) days after the Last Bid Receipt Date.

(d) Bids will be opened in public on the Public Opening Date and Location in Part 1.

(e) Once opened, bids will be held secure and intact. Reasonable efforts will be made to protect them from loss, alteration, or disclosure to any person other than SFH Rwanda, or any person unauthorized by SFH Rwanda. However, SFH Rwanda will not be liable to any bidder for any failure to comply with this Section 2.4(f).

(f) Bids may not be altered, corrected or withdrawn after the Last Bid Receipt Date. In exceptional cases, SFH Rwanda may, at its sole discretion, permit correction of arithmetic errors, transposition errors, or other clerical minor mistakes. This is only possible in cases where SFH Rwanda can clearly identify the mistake and where the intended bid can be established conclusively on the face of the submission.

Beyond arithmetic errors, transposition errors, or other clerical minor mistakes, no mistakes alleged by a bidder after the Submission Deadline will be permitted to be corrected.

### **PART III: TECHNICAL SPECIFICATIONS AND ESTIMATED QUANTITIES REQUIRED**

The company must ensure the quality standards of the materials and should have sufficient stock and operating address that will be verified upon the visit by SFH tender committee delegated members.

## 1. Lots with List and Site Location, Bill of Quantities of works and Architectural Drawings

I. SECTION OF LOTS WITH LIST AND SITE LOCATION: The construction works shall be done as per the following lots with the site visit location:

Lots	ID	Province	District	Sector	Cell	Health Post Name	Status on Existence of FGHP	Date of site Visit and meeting place
<b>LOT-1</b>	1	Eastern Province	Nyagatare	Tabagwe	Nyabitekeri	Nyabitekeri HP	FGHP	<b>Meeting at District Offices at 10h00</b>  NYAGATARE HPs on 24 <sup>th</sup> April 2024
	2	Eastern Province	Nyagatare	Musheri	Nyamiyonga	Nyamiyonga HP	FGHP	
	3	Eastern Province	Bugesera	Ngeruka	Rutonde	Rutonde HP	New site	BUGESERA HPs visit on 25 <sup>th</sup> April 2024
	4	Eastern Province	Bugesera	Nyarugenge	Ngenda	Ngenda HP	FGHP	
	5	Southern Province	Gisagara	Mamba	Muyaga	Muyaga HP	FGHP	GISAGARA HPs on 29 <sup>th</sup> April 2024  Contact Phone: <b>Engineer Donatien:</b> 0788887142
<b>LOT-2</b>	1	Southern Province	Gisagara	Mukindo	Gitega	Gitega HP	FGHP	<b>Meeting at District Office at 10h00</b>  GISAGARA HP on 29 <sup>th</sup> April 2024
	2	Western Province	Karongi	Bwishyura	Gitarama	Gitarama HP	FGHP	
	3	Western Province	Karongi	Bwishyura	Burunga	Burunga HP	New site	KARONGI HPs visit on 30 <sup>th</sup> April 2024
	4	Western Province	Nyamasheke	Karengera	Gasayo	Gasayo HP	New site,	
	5	Western Province	Nyamasheke	Bushenge	Karusimbi/ Mwito	Mwito HP	FGHP	NYAMASHEKE HPs visit on 2 <sup>nd</sup> MAY 2024  Contact Phone: <b>Engineer Donatien:</b> 0788887142

**NOTE:** SITE VISIT IS MANDATORY TO ELIGIBLE BIDDERS, ANY BIDDER WITHOUT A SITE VISIT CERTIFICATE WILL BE DISQUALIFIED.

ALL BIDDERS AT TO MEET AT **THE DISTRICT HQ AT 10H00** SO AS TO MEET SFH ENGINEERS AND DISTRICT ENGINEERS FOR THE SITE VISIT.

---

## II. SECTION OF DETAILED BILL OF QUANTITIES

**Objectives:** The objectives of the Bill of Quantities are:

- (a) to provide sufficient information on the quantities of Works to be performed to enable bids to be prepared efficiently and accurately; and
- (b) when a Contract has been entered into, to provide a priced Bill of Quantities for use in the periodic valuation of Works executed.

In order to attain these objectives, Works should be itemized in the Bill of Quantities in sufficient detail to distinguish between the different classes of Works, or between Works of the same nature carried out in different locations or in other circumstances which may give rise to different considerations of cost. Consistent with these requirements, the layout and contents of the Bill of Quantities should be as simple and brief as possible.

### Daywork Schedule

A Daywork Schedule should be included only if the probability of unforeseen work, outside the items included in the Bill of Quantities, is high. To facilitate checking by the Procuring Entity of the realism of rates quoted by the bidders, the Daywork Schedule should normally comprise the following:

A list of the various classes of labor, materials, and Constructional Plant for which basic daywork rates or prices are to be inserted by the Bidder, together with a statement of the conditions under which the Contractor shall be paid for work executed on a daywork basis. Nominal quantities for each item of daywork, to be priced by each Bidder at daywork rates as Bid. The rate to be entered by the Bidder against each basic daywork item should include the Contractor's profit, overheads, supervision, and other charges.

**BILL OF QUANTITIES & ESTIMATION COST IN ANNEX ATTACHED FOR THE WORKS OF CONSTRUCTION AND BRANDING OF TEN (10) SECOND-GENERATION HEALTH POST (SGHP-Bis) WITH DENTAL AND OPHTHALMOLOGY ROOMS**

**I SUMMARY PAGE PER LOT**

S/N	Description	Number	Unit cost (RWF)
1	Construction of Main House (HP)	1	-
2	External washroom (with the toilets with Disabilities and related external works	1	-
3	Lightning Protector	1	-
4	Other works and external works	1	-
5	Lab bench	1	-
6	Incinerator and Placenta Pits	1	-
	<b>Sub-Total Construction</b>		-
7	<b>Construction of fence</b>	1	-
	<b>Grand Total 18% of VAT inclusive Per LOT</b>		-

**BILL OF QUANTITIES & ESTIMATION COST OF CONSTRUCTION AND BRANDING OF A SECOND-GENERATION HEALTH (SGHPs) WITH DENTAL AND OPHTHALMOLOGY ROOMS**

No	DESCRIPTION	UNIT	QTY	RATE	AMOUNT
<b>I</b>	<b><u>PRELIMINARIES AND EARTH WORK:</u></b>				
1	Site installation, demolition works of existing old houses if any, deviation of existing utility lines (water or electricity), and site clearing including loading and carting away arising debris to a required location and to install the site signal board, the provisional temporary fence, and other related works for the site installation	ff	1.00		-
2	Site Excavation and leveling	ff	1.00		-
3	Excavate for strip foundation 600mm wide and to a depth n.e 0.9m	Cm	76.80		-
4	Excavate for pad foundation 800 x 800mm to a depth n.e 1.2m	Cm	2.30		-
	<b>S/total</b>				-

<b>II</b>	<b><u>SUBSTRUCTURE</u></b>				
	<b>CONCRETE WORKS</b>				
1	Vibrated reinforced concrete M-20, Column bases, sub-columns with steel bar of 4 T 12diam main bars, stirrup T6diam @200mm	Cm	3.77		-
2	Vibrated reinforced concrete M-20, 200 x 200mm thick reinforced insitu concrete continuous ring beam as per structure plan with steel bar of 4 T 12diam main bars, stirrup T6diam @200mm	Cm	6.24		-
3	50mm thick blinding layer in strip fdn	Cm	3.90		-
4	Foundation of 400mm thick approved rubble stone walling bedded and jointed with cement mortar	Cm	56.16		-
5	50mm thick surface blinding on top of foundation	Cm	3.12		-
6	Hessian bituminous felt damp proof course	Lm	160.00		-
	<b>S/total</b>				-
<b>III</b>	<b><u>SUPERSTRUCTURE</u></b>				
1	Burnt clay brick masonry in cement mortar of proportions 1:6	Cm	93.95		-
2.a	Vibrated reinforced concrete 350kg/m3 for column of 200 x 300mm thick with steel bar of 4 T 14diam main bars, stirrup T8diam @150mm	Cm	0.58		-
2.b	Vibrated reinforced concrete 350kg/m3 for column of 200 x 200mm thick with steel bar of 4 T 12diam main bars, stirrup T6diam @200mm	Cm	2.45		-
3	Vibrated reinforced concrete 350kg/m3 For continuous lintel as per structure plan 200 x 200mm thick reinforced with steel bar of 4 T 12diam main bars, stirrup T6diam @200mm	Cm	5.60		-



4	Vibrated reinforced concrete 350kg/m <sup>3</sup> for lintel/beam above the open waiting area (at the verandah) of 200 x 300mm thick steel bar of 3 T 14diam of bars at the bottom and 2T12diam bars at the top of beam and stirrup T8diam @180mm	Cm	0.56		-
5	Ventilation blocks finished with mosquito nets	pce	-		-
	<b>S/total</b>				-
<b>IV</b>	<b>ROOF STRUCTURE</b>				
1	Supply and fix iron sheets (Bacs auto portant - BAP), BG28 pre painted roof cover and fix them to trusses	Sm	313.9		-
2	Steel trusses made of 60x40x1.5mm RHS tubes and Purlins made of 40x40x1.5mm SHS steel tubes including all anti-corrosion(rust) gloss paints	Sm	313.88		-
3	Mild steel gutters 1.5mm thick well finished and painted with oil paint chocolate colored	Lm	29.90		-
4	Mild steel valley gutters 28BG well finished and painted with oil paint chocolate colored	Lm	15.00		-
5	Ridge sheet top flat sheet	Lm	25.90		-
6	Mild steel fascia 1.5mm thickness boards well finished and painted with oil paint chocolate colored	ml	39.22		-
7	Supply and fix appropriate PVC 110 PN6 Plastic downward water pipes with all accessories	Lm	27.80		-
	<b>S/total</b>				-
<b>V</b>	<b>DOORS AND WINDOWS</b>				
1	Painted with light Chocolate Single metallic door size 1000 x 2400mm, The height include transoms of 30cm made in metal louvers for ventilation; Doors must be well finished with original locks Kale Original approved by RSB	N°	4.00		-
2	Sliding metallic doors size 900 x 2100mm, well finished with original padlock locks	N°	1.00		-

3	Varnished Hardwood/plywood door size 900 x 2100mm; well, finished with metallic frame standard HS and original locks Kale Original approved by RSB	N°	13.00		-
4	Painted with light Chocolate Metallic casement window size 1400 x 1500 mm; the height includes transoms of 30cm made in metal louvers for ventilation; the windows must well finish and complete with fasteners	N°	10.00		-
5	Painted with light Chocorate Metallic casement window size 1200 x 1500 mm with sliding part to help in drug distruction at the Pharmacy: well finished and complete with fasteners	N°	1.00		-
6	Painted with light Chocorate Metallic casement window size 700 x 800 mm: well finished and complete with fasteners	N°	4.00		-
7	Provide a Protection Matalic Mounted Frame with lock to be fixed on the wall where a flat TV 32" will be installed in the waiting hall/area	N°	1.00		-
8	supply and fix translucent full-time privacy films preventing vision from both sides on all doors and windows glasses. The type of film is white matt frosted privacy doors and window film or temp white.	sm	31.64		-
	<b>S/total</b>				-
<b>VI</b>	<b>WALL FINISHING &amp; CEILING WORKS</b>				
1	Construction of plinth 150 mm high skirting external and internal wall and around columns	Lm	312.00		-
2	20mm thick plaster on burned bricks walls internally externally mixing ratio 1:4 with the use of river sand Kayumbo type or equivalence	Sm	899.04		-
3	Supply and fix first quality plastic ceiling (Languette) white colored, internal and external; including Hardwood timber ceiling frame of 60x60 spacing all necessary accessories to be approved by the engineer	Sm	266.00		-
	<b>S/TOTAL</b>				-

VII	FLOOR FINISHES				
1	Hardcore in stones 200mm thick under floor bed, including splash apron around the house and drainage including ordinary concrete works prepared to receive the floor tiles	cm	53.2		-
2	500 x 500mm ceramic floor tiles bedded and jointed on prepared backings with clear adhesive. <b>N.B: The sidewalk is with 0.90m of wide</b>	Sm	266.00		-
3	400 x 400mm ceramic floor tiles bedded and jointed on prepared backings with clear adhesive in Laboratory, maternity and washroom	Sm	-		-
4	Ditto 200 x 300 x 6mm white ceramic wall tiles in Laboratory room, maternity and washroom with all required finishing works. The tiles will be constructed such the walls are covered from floor level to ceiling	Sm	78.00		-
	<b>S/TOTAL</b>				-
VIII	PAINTING				
1	Prepare and apply two coats of gloss oil paint black colored on plastered skirting	sm	62.40		-
2	Prepare and apply three coats of first grade plastic emulsion paint on walls. <b>External walls to be painted refer to the perspective photos with Weather guard paints</b> and Internal walls to be painted by <b>using soft white silk paints (pierre de France)</b> . <i>Noted that Wall putty made in mixture of cement-writing-Wood grout and sanding papers have to be used for all interior walls of a building to provide them with a smooth surface before the application of paint. That is, this cement-adhesive ensures that the walls are free of any cracks, holes, and other imperfections, providing them with a perfect base for painting. The painting on rough wall (unsmoothed wall) is not acceptable.</i>	Sm	899.04		-

3	Prepare and apply one coat of undercoat and three coats of gloss paint on steel fascia and barge plates and gutters	ff	1.00		-
	<b>S/total</b>				-
<b>IX</b>	<b>ELECTRICAL INSTALLATION</b>				-
1	Cash power	pce	1.00		-
2	Tubing and Cabling with Oman cables 1.5section and 2.5section	Rlx	18.00		-
3	Single socket outlets	pce	18.00		-
4	1-gang 1-way switch	pce	7.00		-
5	1-gang 2-way switch	pce	8.00		-
6	Economic bulbs	pce	30.00		-
7	Tubing pipes, Junction and MK boxes, circuit breakers, earthing and all accessories, <b>Noted that the sterilization section must be installed separately from other building component installation with its own Rigid cable 3x25mm fusible of above 25A Hagel type of best quality</b>	FF	1.00		-
	<b>S/TOTAL</b>				-
<b>X</b>	<b>SANITARY APPARATUS</b>				
1	Construction of manholes 50x50x50cm with covered by RC slab of 10cm Thick, T8 diam	pce	5.00		-
2.a	Supply and fix water closet (W.C)	pce	1.00		-
2.b	Supply and fix a special water closet (WC) toilet of good quality for <b>persons with disabilities/PWD</b> with wall mounted handrail including installation and fixing and drainage to septic tank.	No	1.00		-
3	Supply and fix wash hand basin, (To be installed in in dental and Ophthalmology room, both Consultation room, Observation room, maternity washroom)	pce	6.00		-

4	Supply and fix mirror	pce	6.00		-
5	Supply and fix double sink in Labo	pce	1.00		-
6	Supply and fix towel holder	pce	6.00		-
7	Supply and fix soap holder	pce	6.00		-
8	Soak pit with top r.c cover filled with stones of 10m with one 1m diam <b>(one pit to collector wastewater from dental unit and second one to collect wastewater from maternity)</b>	pce	4.00		-
9	Installation of plumbing equipment, Drainage works evacuation works with pipes PVC 65 and provisional of <b>siphon de sole</b> (Floor drain) to drain wastewater from dental room, maternity room, sterilization section, washrooms, to the soak pits and including all accessories for connections. <i>Refer to plumbing layout plan</i>	ff	1.00		-
	<b>S/TOTAL</b>				-
<b>XI</b>	<b>WATER SUPPLY</b>				
1	External pipes installation from nearest not more than 50m from the main pipes to the health post including the supply of water-meter and connection by using 3/4 3/4" PVC	ff	1.00		-
2	Construction and installation of external water tap	pce	1.00		-
3	Piping for internal water supply with 3/4" PVC GANGA pipes	ml	45.00		-

4	Supply and fix two plastic storage water tank(PSWT) 5m3; The first PSWT reserved to collect the rainwater from roof gutters shall be installed one the coursed rubble masonry base at least 1m deep stone foundation to ease internal water supply, PVC 110 pipes PN6 with all accessories, <b>The second PSWT reserved for clean water only to be used in dental room, maternity and laboratory</b> , it shall be installed between <b>2.5m -3.5m</b> from ground level on metallic frame of tube 60x40x1.5mm well welded and strongly interlocked to resist to the super imposed load of water tank filled, with columns post fixed into concrete column bases of 80x80x0.35 each base. The water tanks installation shall include all clean water connection from the water source meter through tank to the assigned rooms services, water taps... and all other accessories that may required	pce	2.00		-
	<b>S/TOTAL</b>				-
	<b>Grand total main house HP with 18% VAT Included</b>				-
I	<b>Lightning Protector</b>				
1	Installation de Paratonnerre rayon de protection Equal or greater than 50m. Fourniture et pose paratonnerre N50 rayon de protection 50 m Lightning protection system and Grounding system. The supplier should present the certificate of origin, authorization of manufacturer and model number of air termination rod prior to approval. Air termination should locally have a dedicated testing and inspection kit to test lightning conductor without dismantling, using telescopic pole and test kit: Earth rod electrode, bonding, excavation and related services. Radius of protection >50m, level of protection: zone IIThe tip of Air terminal rod mounted on the tower should be at 60m above the top roof level. Maximum earth resistance :2 Ohms -25x3 mm down conductor and- <b>Inspection chamber and Earth Disconnecting Link.</b>	FF	1.00		-

	<p>supply and install and test complete Flash counter per lightning protection system:          Minimal detectable current: 1kA          Maximum detectable current: 100kA          Ingress of Protection: IP 67          Operating temperature: 0°C to 50°C          Display: Digital, 4 digits</p> <p>Battery: replaceable lithium batteries including fixing clamp to down conductor</p>				
	<b>SUB-TOTAL</b>				-
	<b>Other works and external works</b>				
II	<b>Branding Works</b>				
1.0	Branding the health posts with health messages (see image on attachment) by using the following Banners size:	ff	1.00		-
	Banner of Name of Health Post LOGO 2.95 m by 0.68cm				
	4 Banner 1.5m by 1 m				
	Banner 2m by 1m				
	Banner 1.5m by 80 Cm				
	Banners 1.3m by 70cm				
	Banner 1.3m by 1m				
	Banner 1.5m by 90cm				
	<b>Health Post Plaque:</b> To provide <b>one (1)</b> health post plaque refer to attachment message of grateful appreciation to ..... to be printed on Aluminum sheet of 60cmx40cm size as designed. The post plaque is to be fixed in wall below the flat TV position				
2	Fire extinguisher of 5kg	ff	2.00		-
	<b>SUB-TOTAL</b>				-
III	<b>Landscaping</b>				
1	Gardens with paspalum	m <sup>2</sup>	250.00		-
2	Refer to the site conditions to Provide the paved access ways 1.5m wide to facilitates the people with disabilities to reach out to the health post facilities as a free of barriers, provisional of concrete ramps where required from the existing road to HP to external toilets and other facilities, etc..(process is the Compaction works with	ff	1.00		-

	marram, sub-pavement in hard core and rough pavement mixed at 1:3)				
	<b>SUB-TOTAL</b>				-
	<b>TOTAL EXTERNAL WORKS</b>				-
IV	<b>LAB CORNER WALLS BENCH.</b>				
1	Provisional of lab workbench with frame made in metallic tube 60x40x1.5mm well welded and joited ,	pcs	1.00		-
2	Provisional of top granite slab grey colored 1.8mx0.65m and 30mm Thickness including sharpening, cut to size, polishing and drilling of two holes for cable connection	pcs	1.00		-
3	Supply and fix bench shelve with tyres and drawers made in MDF white colored and the provisional of locks See drawing details	ff	1.00		-
	<b>Sub-Total</b>				-
V	<b>INCINERATOR and PLACENTA PITS</b>				
1	<b>INCINERATOR</b>				
1.1	Excavation	cm	1.69		0
1.2	Foundation works of 40cm death	cm	1.35		0
1.3	Wall masonry in burned bricks binded with pure clay with internal wall plastering by using pure clay	cm	1.17		0
1.4	Reinforced concrete slab on top of incinerator and on soak way pits	sm	0.34		0
1.5	Floor pavement made in hardcore materials and fished with rough cement interna and external around of the incinerator	SM	2.75		0
1.6	A strong metallic sheet plane 4mm thick with holes to allow ashes to easy shift from burning area to the bottom room of ashes	pce	0.45		0
1.7	Metallic chimney fixed according to drawing	SM	1.00		0
1.8	Inlet door with strong tole plane 4mm thick with padlock and to provide an ashes outlet opening according to the drawing plan	Sm	0.32		0
1.9	Excavation of soak way pits of ashes with foundation of one meter death constructed in burned bricks or stone masonry. The pit is with 1 m diameter and 10m death	pcs	1.00		0
	<b>SUB-TOTAL</b>				-
2	<b>PLACENTA PITS</b>				



2.1	Excavation of pit 15 m deep, 1m diam and 2m wide	mc	15.00		-
2.2	Construction works of Foundation 400 mm thick, made in stone with cement mortar of proportions 1:4.	Cm	0.50		-
2.3	Vibrated reinforced concrete for cover with door of metallic cover 40X40 cm size with anticorrosion paint. <b>Noted that the Top slab must be elevated to above 40cm from existing ground level</b>	ff	1.00		-
	<b>Sub-Total</b>				-
	<b>Total (Incinerator and Placenta Pits)</b>				-
	<b>GRAND TOTAL FOR 1 SGHP INCLUDING ALL APPLICABLE TAXES 18%</b>				-

<b>II. EXTERNAL PUBLIC TOILETS</b>					
<b>ITEM</b>	<b>DESCRIPTION</b>	<b>UNIT</b>	<b>QTY</b>	<b>RATE (Rwf)</b>	<b>AMOUNT (RWF)</b>
<b>I</b>	<b>SUB-STRUCTURE</b>				
1	Excavate trench for strip foundation trench not exceeding 1 m deep from stripped level and the pits of septic tank 4mx1.6m sqm, 3.5m depth with bottom sloping at 15%	CM	64		-
3	Construct 400mm thick rubble stone walling of the septic tank and foundation around with cement and sand (1:4) mortar	CM	15		-
4	Allow for damp proof course, pvc type, thickness 1-2 mm and width 1-2 m.	ML	11		-
	<b>Concrete works</b>				
5	Sub pavement made in stone hardcore materials at the bottom of the septic tank finished with a smooth cement mortar 1:3 + admixture products sika with the provisional of 15% of slop	SM	6		-





7	Wall plastering of the septic tank finished with a smooth plaster mixed at 1:3 with cement admixture products sika, etc...	SM	39		-
8	Reinforced concrete slab 2.2mx5m, 12cm thick, using steel bar T10 spaced @20 with double reinforcement to cover the septic tanks and provisional of Drop holes of 15-20cm Diameter and manholes as indicated	SM	0.96		-
9	Cement and sand (1:3) paving and provisional and apply the floor tiles 40x40 or 50x50 for the entire pavement floor and sidewalk	sm	32		-
10	To construct an access ways ramps made hardcore materials for sub pavement and finished with ordinary concrete mixed at 1:3 to facilitate the wheelchair user to access the washrooms	ff	1		-
<b>Carried to collection</b>					-
II	<b>SUPER STRUCTURE</b>				
	<b>WALL ELEVATION</b>				
1	Masonry walling: 7x21 x 9 cm Burnt bricks or compacted block cement with 20x40 cement and sand (1:4) mortar	CM	17.34		-
2	15mm thick rendering and 5mm, smooth cement and sand (1:4) mortar plaster on burnt bricks of internal walls.	SM	156.06		-
3	Ditto 200 x 300 x 6mm white ceramic wall tiles in Laboratory room, maternity and washroom with all required finishing works.	SM	46.2		-
<b>Carried to collection</b>					<b>0</b>
	<b>Roof structure and Roof Covering</b>				
2	Metallic trusses 40x401.5 including hoisting and fixing in position at an average height of approx.3.8 m above ground level of good quality approved by the engineer. (Frames, purlins)	sm	18		-

3	Roof covering, Fix Gauge 28 tiles forming iron sheets blue color on to metallic purlins with galvanized roofing nail to lap not less than 200mm longitudinally and by 1 corrugation laterally of good quality approved by the engineer.	SM	18		-
2	Mild steel gutters 1.5mm thick well finished and painted with oil paint chocolate colored	ml	5.2		-
3	Mild steel fascia 1.5mm thickness boards well finished and painted with oil paint chocolate colored	ml	5.2		-
7	Supply and fix appropriate PVC 90 PN6 Plastic downward water pipes and <b>Aerations pipes</b> with Top T joint, screened wire nets all accessories	Lm	18		-
<b>Carried to collection</b>					<b>0</b>
<b>Door and Windows</b>					
1	Single metallic door size 800mm x 2100x1.25 mm	pce	4		-
2	Single metallic door size 1100mm x 2100x1.25 mm for toiles of People with disabilities, noted that the handle or cellular lock have to be fixed bellow 90cm height from ground level to facilitate the wheelchair users to open the doors and to close easily	pce	1		-
<b>Carried to collection</b>					<b>0</b>
<b>PLUMBING WORKS</b>					
2	Supply and fix ceramic wash hand and provisional of all required accessories	No	2		-
3	Supply and fix the new water closet (WC) toilet of good quality with wall mounted handrail for persons with disabilities PWD including installation and fixing and drainage to septic tank. Those are to be installed in expansion room as indicated on drawing	No	1		-

4	Supply and fix the wash hand installed at 50cm height from ground level to serve the persons with disabilities PWD including installation and fixing and drainage to soak pits. Those are to be installed in expansion room as indicated on drawing	No	1		-
5	To supply the toilets paper holder	No	4		-
6	Soak pits 12m depth with RC top cover to correct used water and water from roof covering, bathroom, and overflow water from septic tank	no	1		-
7	Allow the supply of clean water, all evacuation pipes	ff	1		-
<b>Carried to collection</b>					-
<b>ELECTRICAL INSTALLATION</b>					
1	Supply and fix electric wires of 1.5 mm	Rlx	1.50		-
2	Supply and fix Lamps bulbs of 12W externally and internally	pce	2.00		-
3	Supply and fix switches: SA, DA, DD various types	pce	2.00		-
4	Supply Connection boxes	pce	2.00		-
5	Tuyaux 5/8 " PVC for roof wiring	pce	6.00		-
<b>Carried to collection</b>					-
<b>TOTAL COST OF Public toilets with 18% VAT Included</b>					
					-

<b>CONSTRUCTION OF FENCE OF AVERAGE SIZE 45.1X35.4M, Avarage Length=155 m</b>					
<b>No</b>	<b>DESCRIPTION</b>	<b>UNIT</b>	<b>QTY</b>	<b>RATE</b>	<b>AMOUNT</b>
1	Excavate for strip foundation 600mm wide and to a depth n.e 0.8m	Cm	65.1		-
2	Foundation of 400mm width and depth of 900mm approved rubble stone walling bedded and jointed with cement mortar and retaining walls where applicable	Cm	100.75		-
3	Burnt clay brick masonry in cement mortar of proportions 1:6 and well finished	Cm	55.8		-
4	50mm thick surface blinding on top of foundation	Cm	3.1		-
5	50mm thick surface blinding on top of bricks	Cm	3.1		-
6	Supply and fix of entrance gate (2.0x4) made in metal sheet with metallic tube 40x40x1.5, 60x40x1.5 inbuilt single door with lock original kale and Padlock for gate	pce	1		-
<b>TOTAL FOR FENCE with 18% of VAT INCLUDED</b>					-

## ARCHITECTURE DESIGNS:

	<p><b>REPUBLIC OF RWANDA</b></p> <p><b>PROJECT: PROPOSED DESIGN OF SECOND-GENERATION HEALTH POST, (SGHPs) WITH DENTAL AND OPHTHALMOLOGY ROOMS</b></p>	
		
<p><b>TECHNICAL DOCUMENT:</b></p> <ol style="list-style-type: none"> <li>1. Perspectives</li> <li>2. Floor plan view SGHP with dental and ophthalmology rooms</li> <li>3. Section elevation</li> <li>4. Front and back view elevation</li> <li>5. Side Views elevation</li> <li>6. Electrical Layout Plan</li> <li>7. Plumbing and Sanitation Layout plan</li> <li>8. Lightening Protection layout-</li> <li>9. Design of Laboratory corner bench</li> <li>10. Design of incinerator</li> <li>11. Design of public toilets</li> <li>11. Bills of quantities and estimated cost of the project.</li> </ol>	<p><b>DESIGNED BY:</b></p> <p><b>THE SOCIETY FOR FAMILY HEALTH (SFH) RWANDA</b>  <b>A member of Population Services International (PSI) Global Network</b>  <b>P.O.Box 3040 Kigali, Rwanda,</b>  <b>Email: info@sfhrwanda.org</b></p> <hr/> <p><b>APPROVED BY:</b></p> <p><b>MINISTRY OF HEALTH</b></p>	





**SECOND GENERATION HEALTH POST WITH DENTAL AND  
OPHTHALMOLOGY SERVICES**

Drawing: PERSPECTIVE 1

DESIGNED BY: SFH-RWANDA

APPROVED BY: MINISTRY OF HEALTH





**SECOND GENERATION HEALTH POST WITH DENTAL AND  
OPHTHALMOLOGY SERVICES**

Drawing: PERSPECTIVES 2

DESIGNED BY : SFH-RWANDA

APPROVED BY : MINISTRY OF HEALTH







**SECOND GENERATION HEALTH POST WITH DENTAL AND  
OPHTHALMOLOGY SERVICES**

Drawing: PERSPECTIVE

DESIGNED BY: SFH-RWANDA

APPROVED BY: MINISTRY OF HEALTH









**SECOND GENERATION HEALTH POST WITH DENTAL AND  
OPHTHALMOLOGY SERVICES**

Drawing: ELEVATION SIDE VIEW

DESIGNED BY :	SFH-RWANDA
APPROVED BY :	MINISTRY OF HEALTH





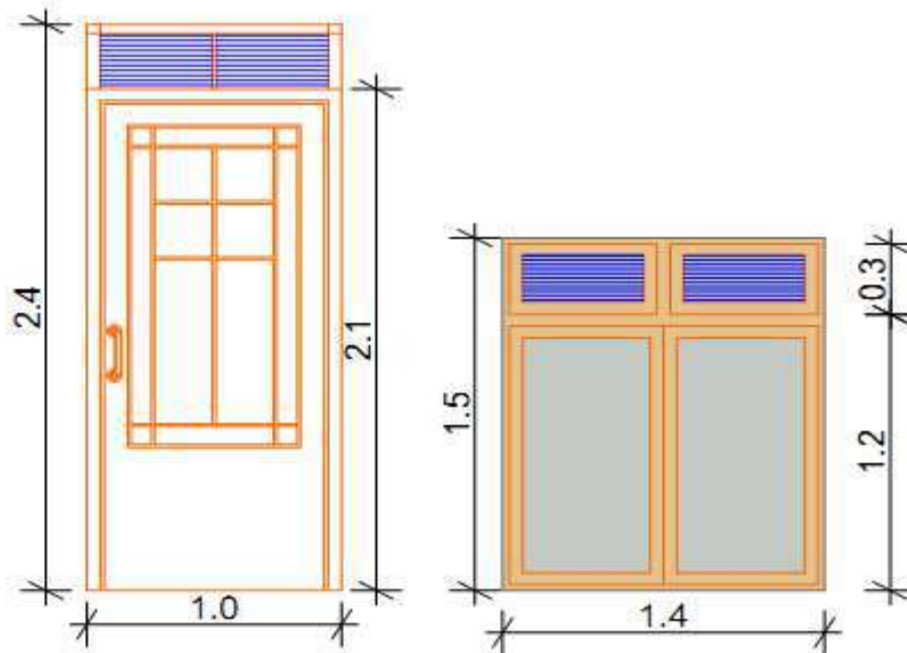

## Metallic Doors and Windows

### Window details (Dubai style):

<b>Frame</b>	made in tube of 40x40x1.25mm
<b>Grillage/Grilles</b>	made in tube 20x20x1.25 to be fixed inside of the house
<b>Sash Frame/ouvrant</b>	made in tube 40x20x1.25
<b>Glasses</b>	Normal glasses, 3mm thick and to provide translucent privacy film Glasses to be outside and window Grille to fix inside

### Doors details (Dubai style):

<b>Frame</b>	made in tube of 60x40x1.25mm
<b>Grillage/Grilles</b>	made in tube 20x20x1.25 to be place inside
<b>Sash Frame/ouvrant</b>	made in tube of 60x40x1.25mm
<b>Toile plane</b>	from of 90cm height from
<b>Glasses</b>	Normal glasses, 3mm thick and to provide translucent privacy film Glasses to be outside and window Grille to fix inside
<b>Temporary bottom rail</b>	made in steelbar T12 diam to maintain the frame integrity during installation

### **SECOND GENERATION HEALTH POST WITH DENTAL AND**

### **OPHTHALMOLOGY SERVICES**

Drawing: METALLIC DOORS AND WINDOWS DETAILS

DESIGNED BY: SFH-RWANDA

APPROVED BY: MINISTRY OF HEALTH





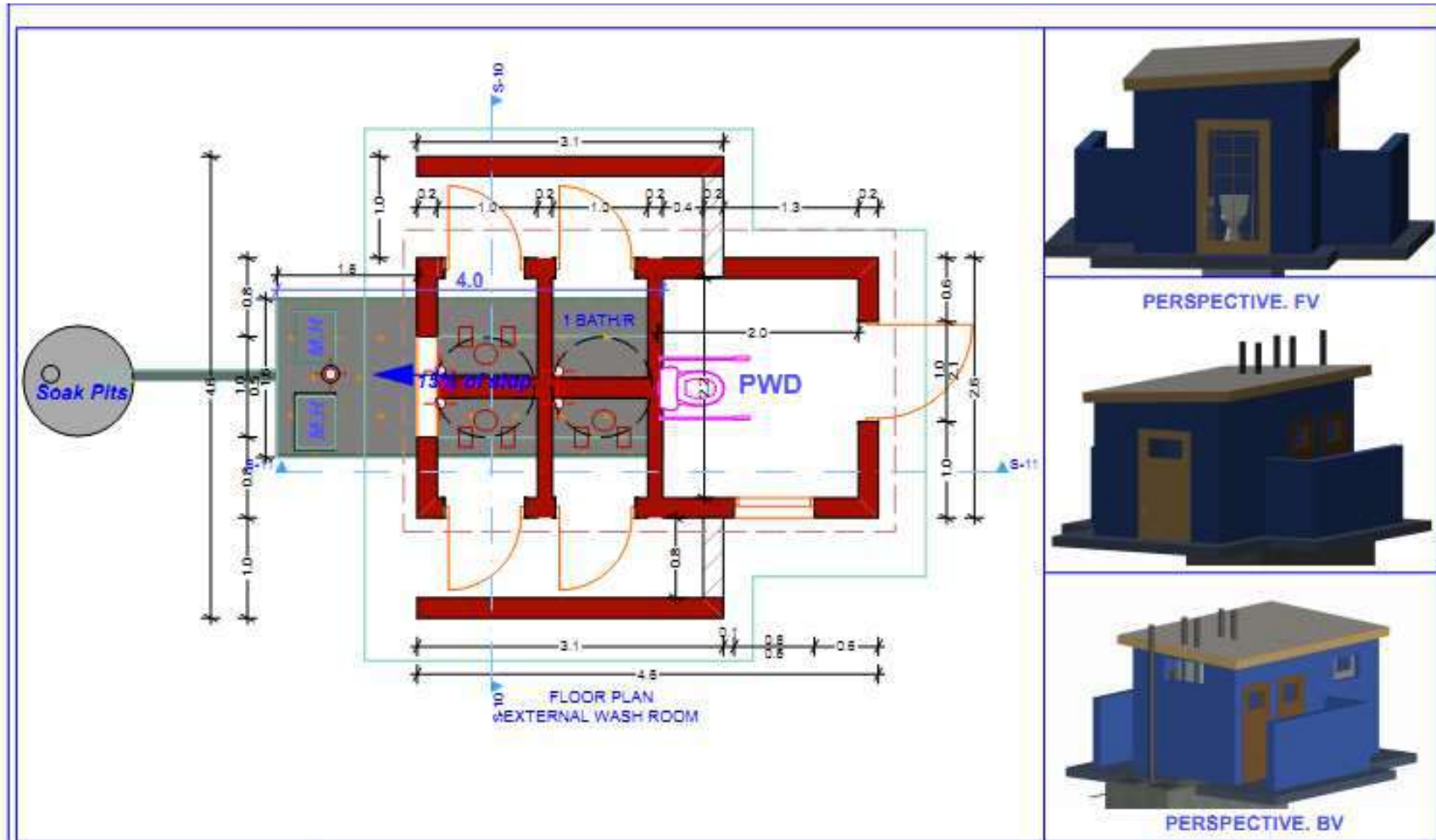

**SECOND GENERATION HEALTH POST WITH DENTAL AND OPTHALMOLOGY SERVICES**

Drawing: TOILETS

DESIGNED BY : SFH-RWANDA  
 APPROVED BY : MINISTRY OF HEALTH



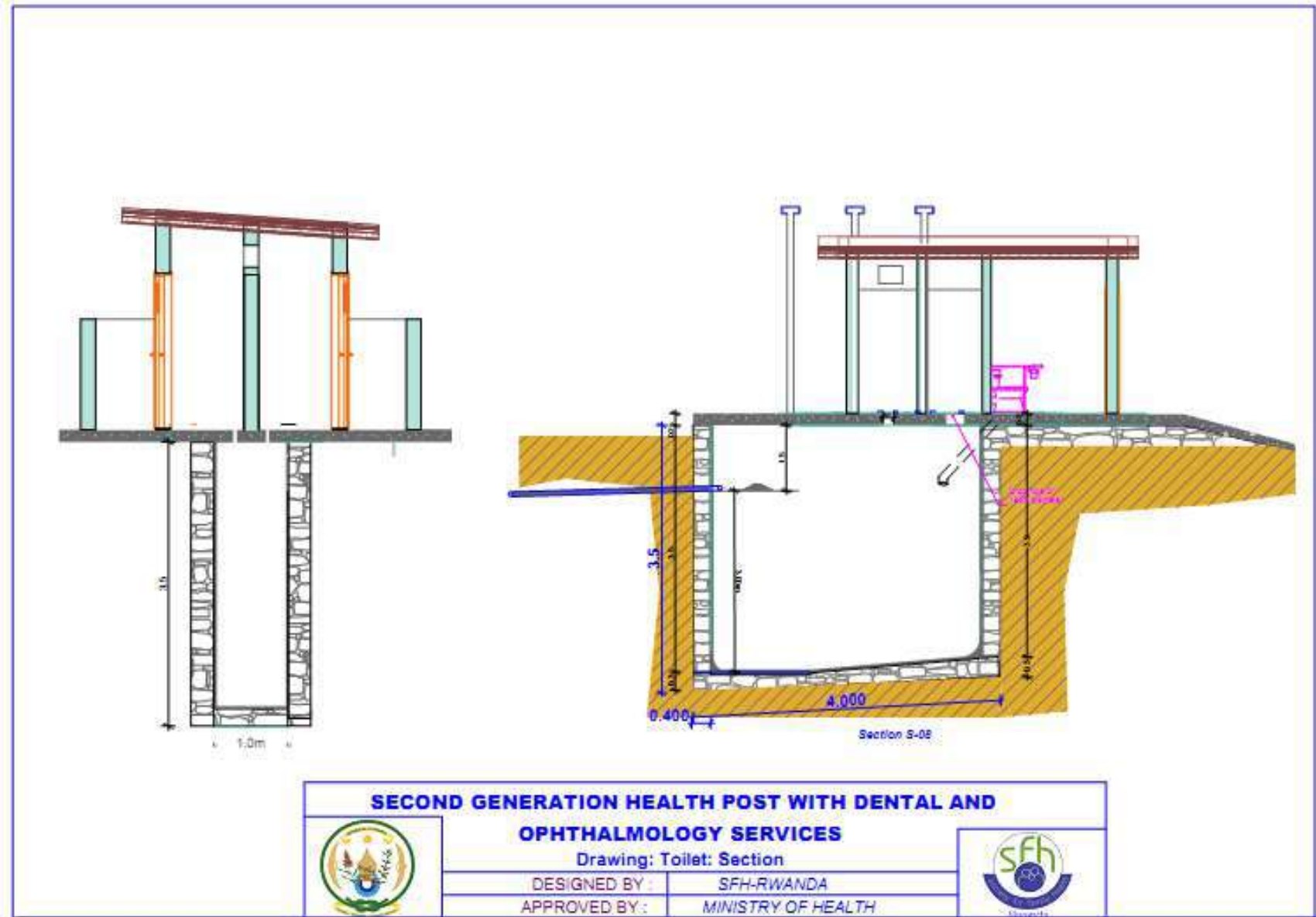



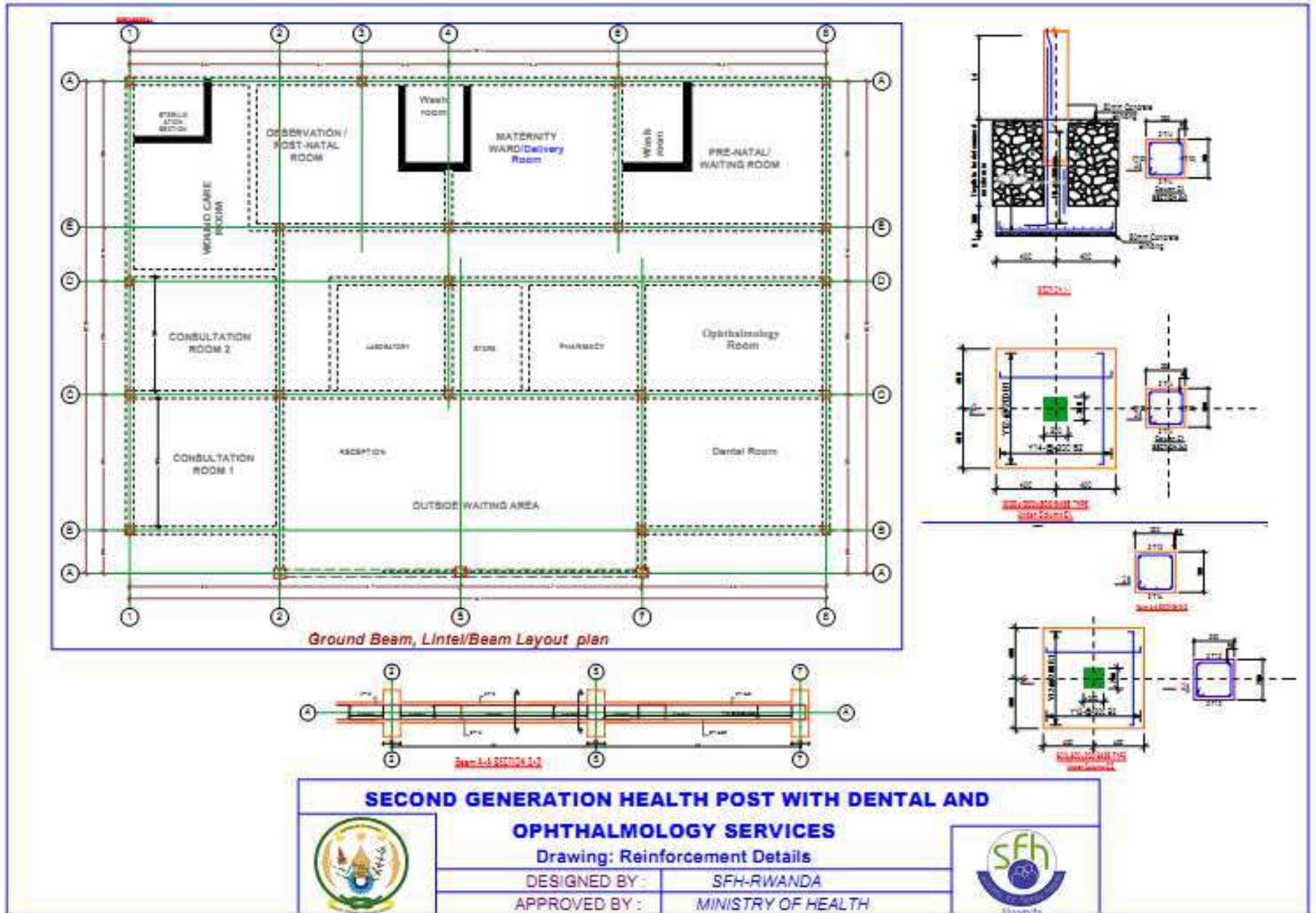

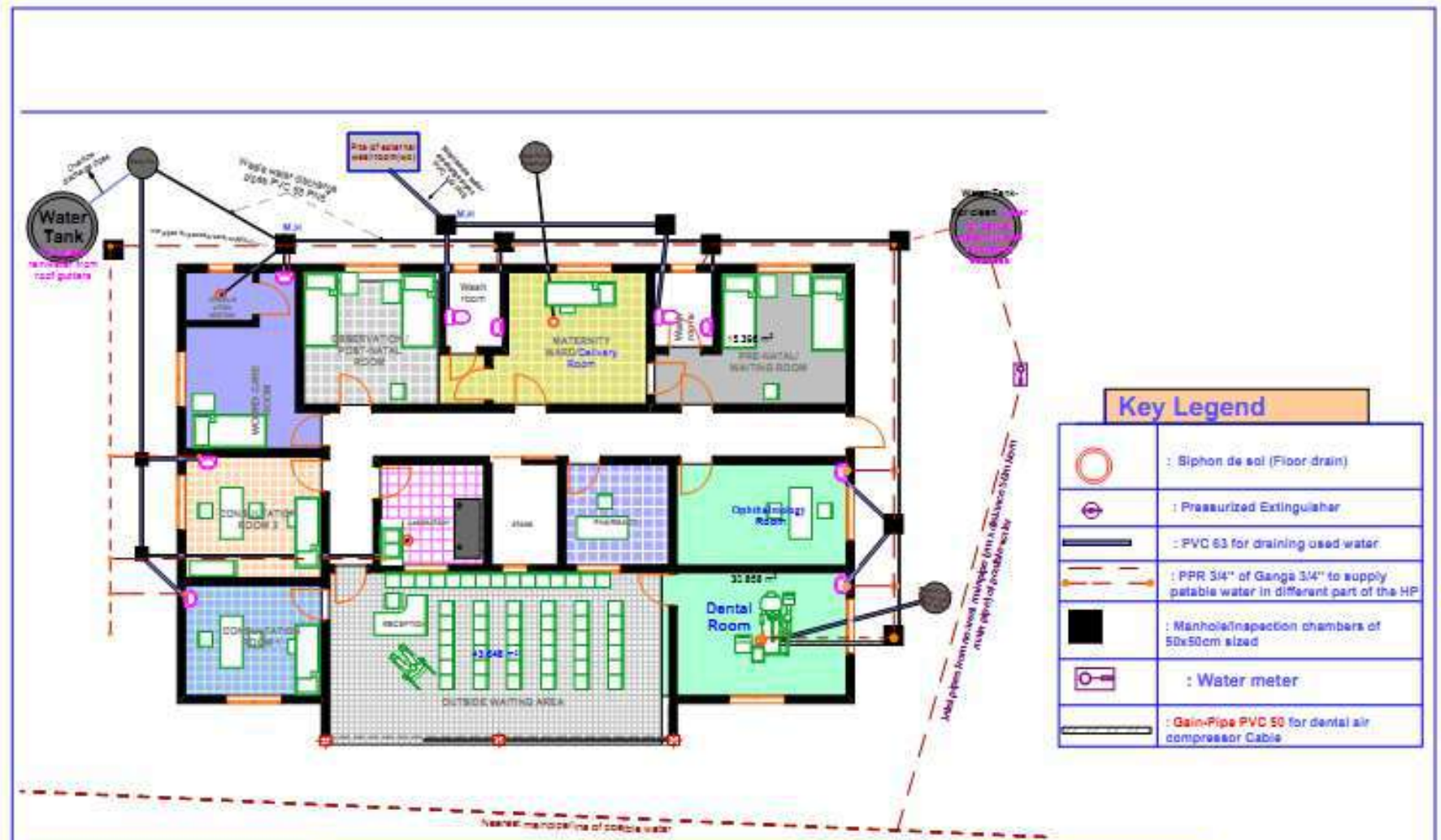

**Key Legend**

	: Biphon de sol (Floor drain)
	: Pressurized Extinguisher
	: PVC 63 for draining used water
	: Manhole/inspection chambers of 50x50cm sized
	: Water meter
	: Gain-Pipe PVC 50 for dental air compressor Cable

**SECOND GENERATION HEALTH POST WITH DENTAL AND OPHTHALMOLOGY SERVICES**

Drawing: PLUMBING AND SANITATION LAYOUT PLAN

DESIGNED BY : SFH-RWANDA

APPROVED BY : MINISTRY OF HEALTH





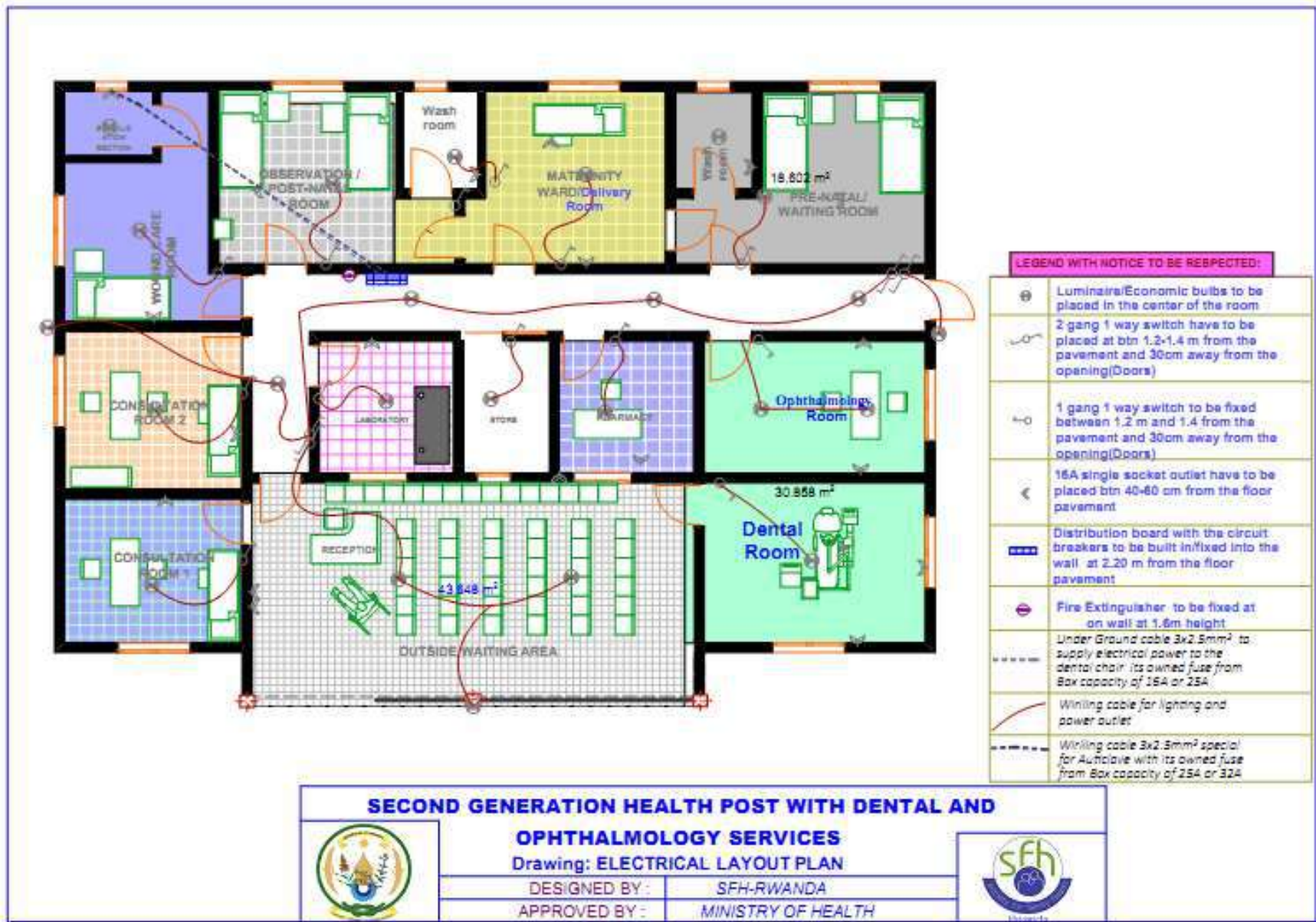

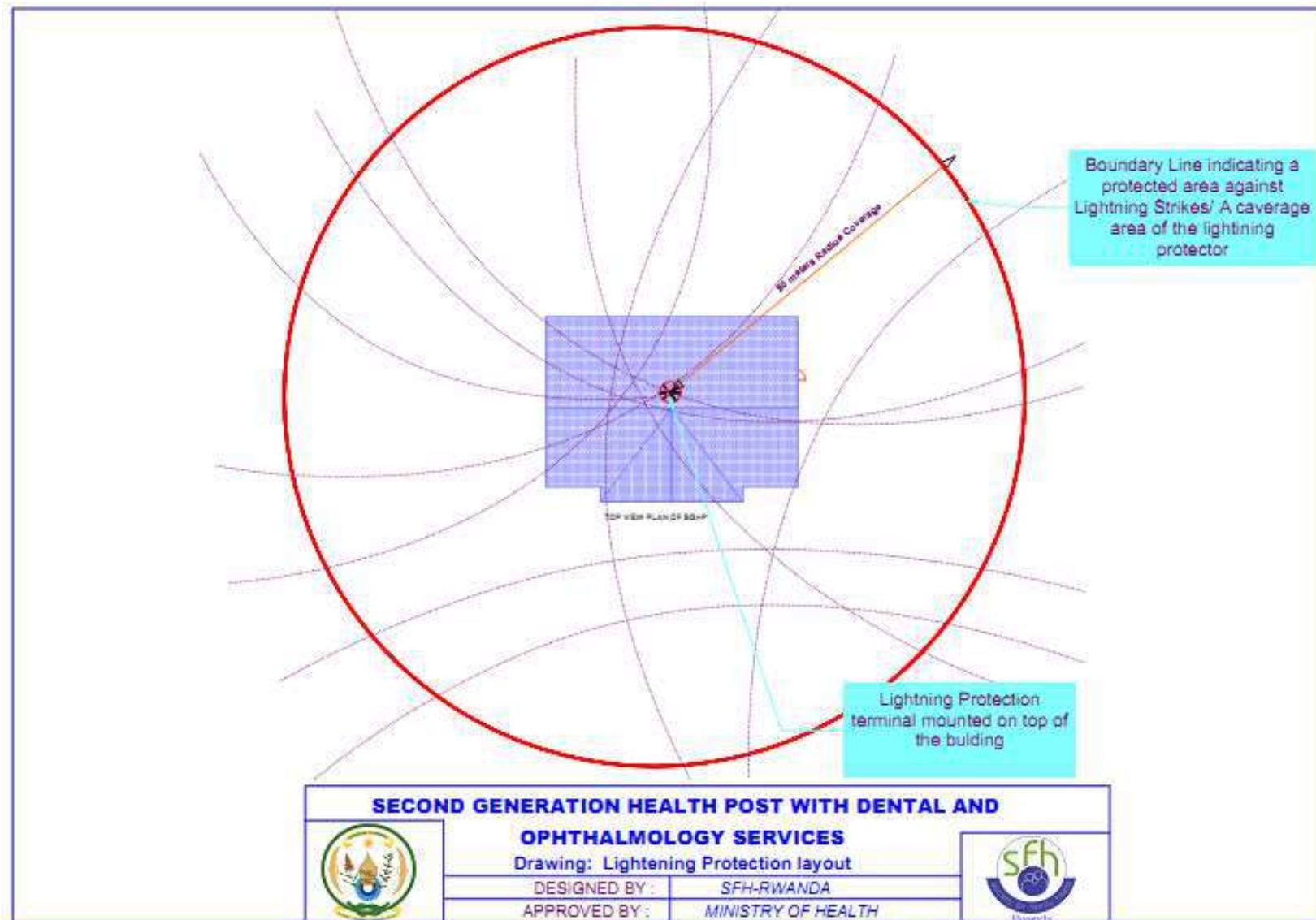









---

## **PART V: STANDARD PROVISIONS**

### **V.1 Definitions and Headings**

Except otherwise provided contrary to what is herein, all time periods specified shall be consecutive calendar days. The term “Tender Package” refers to the entire document, including all attachments thereto. Any headings contained in the text of the Tender Package are for reference only, and do not alter, limit, or waive the content of the full provisions.

### **V.2 Donor Guidelines and Policies**

(a) The procedures followed by SFH Rwanda in making any award and contract resulting from this Tender Package, as well as the terms and conditions of such award and contract, will be based on the SFH Rwanda *Procurement Manual*.

(b) Prospective companies providing this service should also note that a primary requisite for SFH Rwanda is to obtain the most valuable offer on the current market. Whenever possible, bids are sought on a competitive basis, and all prices offered will be subject to detailed scrutiny and, possibly, negotiation, if necessary, to ensure reasonable contract price is obtained.

### **V.3 Tender Package**

This Tender Package should not be considered an award or contract as it is intended solely for the provision of information to prospective service providers.

### **V.4 Review of Tender Package**

Prospective service providers are solely responsible to examine carefully all of the terms and conditions of this Tender Package. Failure to do so will be at the prospective supplier’s risk and expense, and any items requested by SFH Rwanda but not submitted by bidder are grounds for disqualification from the tender.

Any ambiguities in the technical specifications and standards or inconsistencies between or among the various provisions of the Tender Package shall be resolved against the prospective Service provider if she/he fails to seek clarification prior to award.

### **V.5 Probity and Ethics**

In the purchasing efforts SFH Rwanda follows, and by virtue of the submission of their bids, all bidders commit to follow the guidelines contained in the SFH Rwanda *Procurement Manual*.

### **V.6 Language**

All documents submitted in response to this Tender Package, as well as all correspondences in connection with the Tender Package, shall be in the language specified in Section II.1, always in English. The final contract will be written and signed in English.



## V.7 Inquiries

Inquiries concerning this Tender Package and any return bid(s) must be submitted in writing ten days before the submission deadline to permit a thorough and accurate response by SFH Rwanda. Such inquiries shall be sent by telephone at +250(0) 788305685 or by email through [procurement@sfhrwanda.org](mailto:procurement@sfhrwanda.org) using the contact information included in Section II.1. SFH Rwanda is under no obligation to consider or respond to questions that are not received in a timely manner.

## V.8 Evaluation of Bids

### A. ADMINISTRATIVE CRITERIA

The bidders must provide the following administrative documents:

- Copy of Business Registration certificate or Certificate of domestic Company Registration allowing the company to do Business.
- Valid Original tax clearance certificate (attestation de non-creance) from RRA
- Copy of Site visit Certificate (a must) provided by SFH. NB. During site visits service providers will sign a form provided by SFH. Bidders will sign on the visit attendance list.
- Valid Original Contribution clearance certificate from RSSB
- Bid Security shall be in RWF of the Bidder's contract estimate per LOT of 2% of the Total Bid Price.
- Certificate of Good Standing for non-bankruptcy delivered by RDB.
- Proof of payment of a non-refundable fee of Fifty thousand Rwandan francs (50,000Rwf) paid into: BANK NAME: ACCESS BANK (RWANDA) LTD

ACCOUNT NAME: SOCIETY FOR FAMILY HEALTH RWANDA

ACCOUNT NUMBER: 1002190101953001

CURRENCY: RWF

The Company that will not have filled any of aforesaid conditions will be eliminated and their bids will not be considered for the next evaluation stage.

### B. TECHNICAL CRITERIA 40%

#### 1. Evaluation of Bids on Methodology composed of:

- a) Assessment of adequacy of Technical Proposal with Requirements scored at 2 marks.

The assessment of the Technical Proposal submitted by a Bidder shall comprise (a) evaluation of the Bidder's plan to mobilize key equipment and key personnel to carry out the works, (b) construction method, (c) construction schedule and (d) sufficiently detailed supply sources,

**b) Assessment of adequacy of the Environmental, Social, Health and Safety (ESHS) Methodology scored at 3 marks.**

The ESHS Methodology submitted by the Bidder shall be evaluated to determine whether it is substantially responsive (i.e. without material deviation, reservation, or omission) - ESHS Specifications. A Bid not comprising an ESHS Methodology or a Bid for which the ESHS Methodology is not substantially responsive (i.e. with material deviation, reservation, or omission) shall be rejected.

**2. Company profile and Personnel Requirements**

- The period of General Company experience in construction should be above five (5) years: A minimum number of four (4) similar contracts that have been satisfactorily and substantially completed as a contractor, or joint venture member in that period scored at 2 marks.
- General Construction & Contract Management experience: Showing at least FOUR (4) references with relevant certificates of completion of works from previous client (s) scored at 4 marks.
- Construction Experience in key similar activities with a minimum construction experience in the following key activities successfully completed: Such as Health posts, health centers, hospitals that were constructed at least Two (2) references with relevant certificates of completion of works from previous client (s). scored 8 marks.

**Note that NO joint venture shall NOT be applicable in this tender. Note that the requested certificate should range within the past (7) seven years from 2018 to 2024.**

**3. Equipment Requirements: scored at 10 marks.**

A Bid not including proposed list of equipment per Lot or a Bid for which the proposed equipment is not substantially responsive shall be rejected. The Bidder must demonstrate that it can obtain (purchase, lease or rent) the key equipment listed hereafter:

No.	Equipment Type and Characteristics	Minimum Number required
1	Track of above 15 Cubic meters	3
2	Tipper Trucks (5 tonnes),	3
3	double cabinet vehicles,	1
4	welding machine	2
5	Generators of 3 KVA $\approx$ 380 or 220.	2

*For the purposes of due diligence if needed, SFH tender committee may be before the tender award visit the bidder(s) at its premises of work to assess the capacity.*

*To provide the proof of ownership or agreement with the supplier of the equipment mentioned above.*

#### **4. Personnel scored at 11 marks.**

The Bidder's personnel shall be evaluated to determine whether it is substantially responsive. A Bid not including proposed list of personnel is not substantially responsive shall be rejected.

<b>No.</b>	<b>Position</b>	<b>Total Work Experience (years)</b> (Join a detailed, signed, and updated CV; certified copies of degrees; statement of exclusivity and availability signed by proposed staff.)	<b>In Similar Works Experience (years)</b>
1	The Project Manager/ Civil Engineer: in Charge of the whole project	A0 Civil Engineer with minimum 10 years' experience in similar works and He must be certified by the Institute of Engineer of Rwanda with the valid certificate, VALID.	10 years
2	The Assistant Project Manager in Charge of the whole project	A0 Civil Engineer with minimum 7 years' experience in similar works and He must be certified by the Institute of Engineer of Rwanda with the valid certificate VALID	7 years
3	Five (5) site foremen per LOT:	A2 diploma in construction or public works with minimum 5 years of experience in similar construction works or similar supervision works. However, the number of foremen during implementation shall depend on the number of sites awarded to the construction company such that each site will have its specific permanent foreman.	7 years
4	ESHSE Manager in Charge of the whole project	10 years in designing and monitoring the implementation of ESHS management plans for construction works in Charge of the whole project	10 years
5	Health and Safety (HS) Manager	<u>10 years</u> in designing and monitoring the implementation of ESHS management plans for construction works in Charge of the whole project	10 years
6	External Stakeholders Relations Manager	<u>10 years</u> in designing and monitoring the implementation of ESHS management plans for construction works in Charge of the whole project	10 years
7	Community Liaison Officer	Fluency in Kinyarwanda should be mandatory for this position with at least Secondary level Education in Charge of the whole project	10 years

### C. FINANCIAL CRITERIA 60%

The financial criteria to be followed will be based on the lowest price that will be most preferred after the technical criteria score. The overall winner will be determined after combining both Technical and Financial Scores for companies that have been prequalified.

- **Financial Capabilities: Other Sources of Finance:** The Bidder shall also demonstrate, to the satisfaction of SFH, that it has adequate sources of finance to meet the cash flow requirements on works currently in progress and for future contract commitments. scored 20 marks.
- **Financial Capabilities: Financial Position:** The audited balance sheets or financial statements acceptable to SFH Rwanda, for the last 3 years shall be submitted and must demonstrate the current soundness of the Bidder's financial position scored at 5 marks. based on the following criteria:

- a) Liquidity ratio  $\geq 1.1$

$$\frac{\text{Current Assets}}{\text{Current Liabilities}} \geq 1.1$$

- b) Indebtedness ratio  $\leq 80\%$

- **Average Annual Construction Turnover:** *[As an indication, the specified amount should range between 1.5 and 2 times the estimated annual invoice amount under the contract]* Minimum annual construction turnover of *[insert amount in RWF equivalent in words and figures]*, for the last 3 years, calculated as total certified annual payments received for contracts in progress and/or completed. scored 5 marks.

### V.9 AMENDMENTS

If at any time prior to award SFH Rwanda deems there to be a need for a significant modification to the terms and conditions of this Tender Package, SFH Rwanda will issue such a modification as a written Tender Package amendment to all competing bidders using an addendum posted through all the channels used in sending out the tender package. No oral statement of any person shall in any manner be deemed to modify or otherwise affect any Tender Package term or condition, and no bidder shall rely on any such statement.

### V.10 PRICE VERIFICATION

If adequate competition is not achieved in the tendering process, the right is reserved for any otherwise compliant bid to be referred to SFH Rwanda who may, at their discretion, authorize a price verification exercise to be undertaken on their behalf by an organization or delegated SFH Staff. In such an eventuality, the bidder will be required to give details of the services tendered for, together with details of any costing used or undertaken in preparing the bid.

## **V.11 EXTENSION OF BID VALIDITY DATES**

When necessary and appropriate under the circumstances, SFH Rwanda may request bidders, in writing, to extend the validity period of their bids and Bid Securities (if any). A bidder may refuse to extend its bid; however, its bid will be disqualified. A bidder agreeing to extend will not generally be permitted or required to modify their bid in any manner other than to extend it.

## **V.12 REJECTION OF TENDERS**

(a) SFH Rwanda is not bound to accept the lowest bid and reserves the right to reject any tender in whole or in part and to reject any or all tenders without assigning any reason. Circumstances in which rejection of all bids may occur include, without limitation, the following:

- (1) none of the bids is adequately responsive to the specifications,
- (2) there is evidence of insufficient competition,
- (3) the lowest bid exceeds the estimated value or funds available and cannot be reduced by negotiation,
- (4) the quality of the tender is deemed insufficient.
- (5) the technical or financial bases of procurement have changed materially prior to the award,  
or
- (6) The prices of the bid are obviously and clearly high.

## **V.13 TERMS OF AWARDS**

- (a) All awards are subject to the availability of adequate funds from SFH Rwanda and the receipt of all required approval from SFH Rwanda and the donors.
- (b) Upon receipt of SFH Rwanda and/or the indenter's approval of the recommended award, to the extent required, SFH Rwanda will send a Notice of Award to the winning bidder and will inform unsuccessful bidders that they have not been selected.

## **IV.14. Notification of Tender Award**

The bidder whose proposal attains the highest score, in accordance with the evaluation criteria in the present request for proposals shall be selected for award, subject to satisfactory conclusion of negotiations if deemed necessary.

The procuring entity shall notify the successful bidder of its selection results and at the same time inform other unsuccessful bidders of the decision. In the absence of a challenge by any other bidders within seven (7) days of the notice, the contract shall be signed by both parties.

**IV.15. PAYMENT TERMS**

SFH Rwanda undertakes to pay an advance payment of the Contract Value upon presentation of an EBM invoice of 30% as advance; with a performance guarantee of 5% of Total Financial cost from a financial institution.

Second Instalment shall be paid upon presentation of an invoice of 40% of the total contract value and approved Construction works report with progress work at 70%.

The third payment of 25% shall be made after the Services have been performed in full by Construction Company with Provisional Handover Reports approved by Society for Family Health (SFH) RWANDA teams proportions to which the Accepted Contract Amount is payable and 5% to be retained and given out at the Final Handover of the Health Posts.

SFH Rwanda welcomes your bid in this competitive process,

Sincerely,

Manasseh GIHANA WANDERA  
**Executive Director**